

# PIANO TERRA

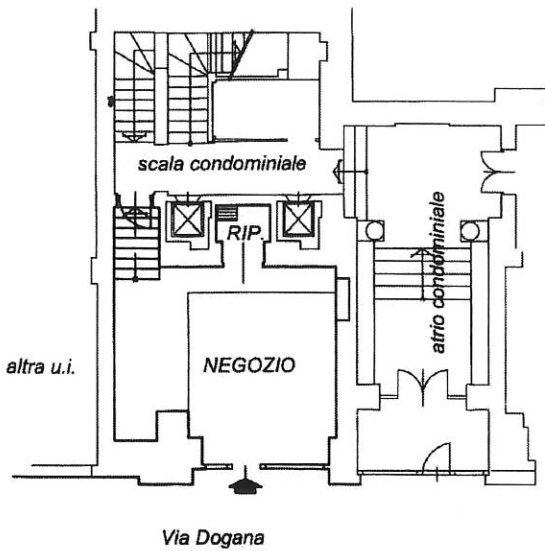

# PIANO SOPPALCO

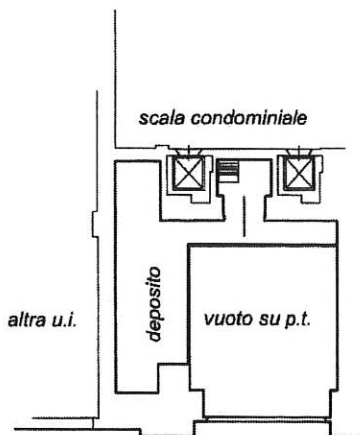

superficie DPR 138/98	
piano terra	$38.14 + 2.61 * 0.5 = 39.45$
soppalco	$19.84 * 0.5 = 9.92$
<b>totale</b>	<b>49.37 mq</b>

**ESTRATTO DI MAPPA**  
Foglio 390 mapp. 178  
Scala 1:2000

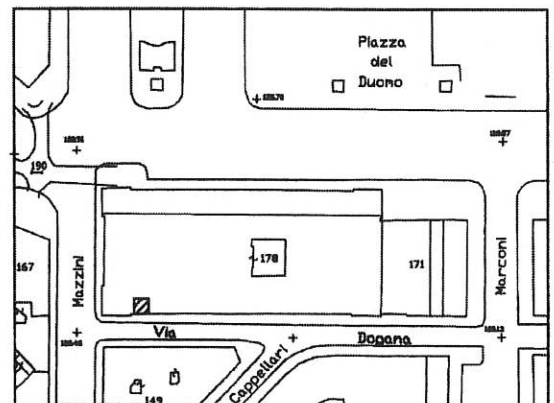

**COMUNE  
DI  
MILANO**

Settore Demanio e Patrimonio  
Servizio Tecnico Immobiliare

Tecnico: R.I.

Rilevatore:

Scala: 1:200

Dis.n. **unica**

Oggetto :

**Via Dogana n° 4**

Titolo:

**Piano Terra/Soppalco**